

# AirBear Connection Settings for Android

Step 1: Find your Settings Icon

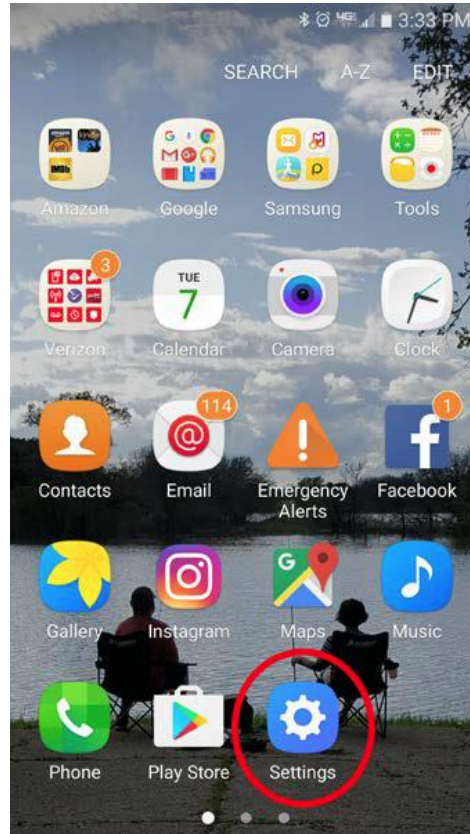

Step 2: Tap on Wi-Fi

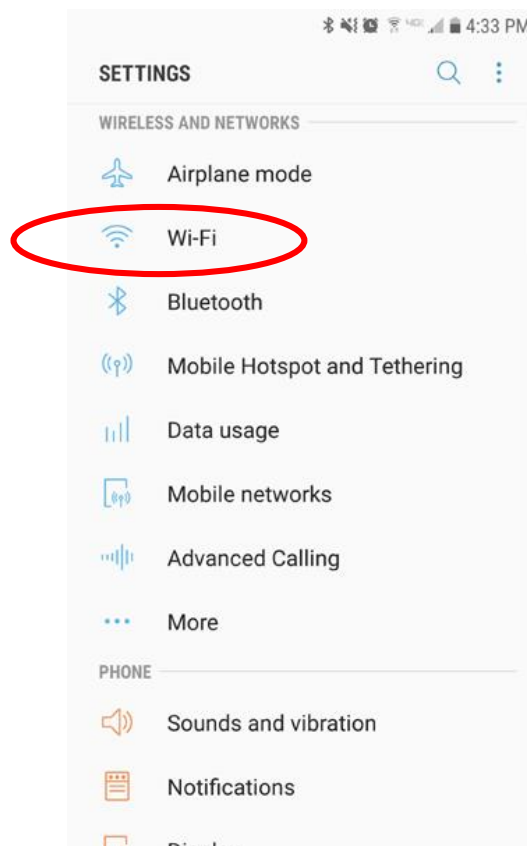

Step 3: Make sure Wi-Fi is turned on, then tap on AIRBEAR WPA2.

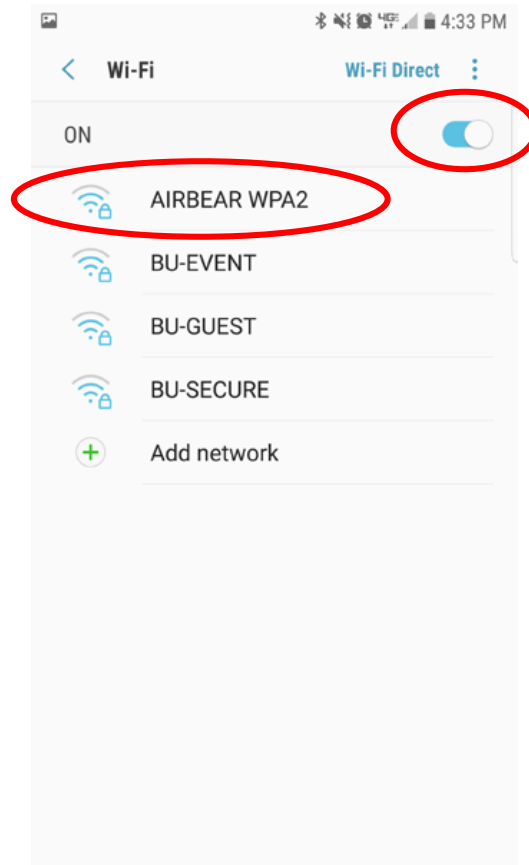

Note: For the CA Certificate, you may need to set it to "Do Not Validate"

Step 4: Enter your BearID for Identity, then enter your password.

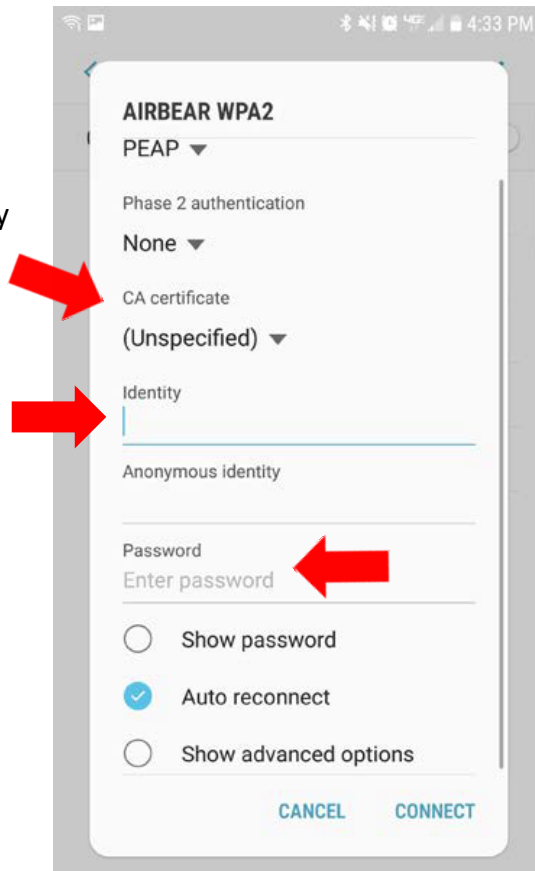

Step 5: Your screen should look like this:

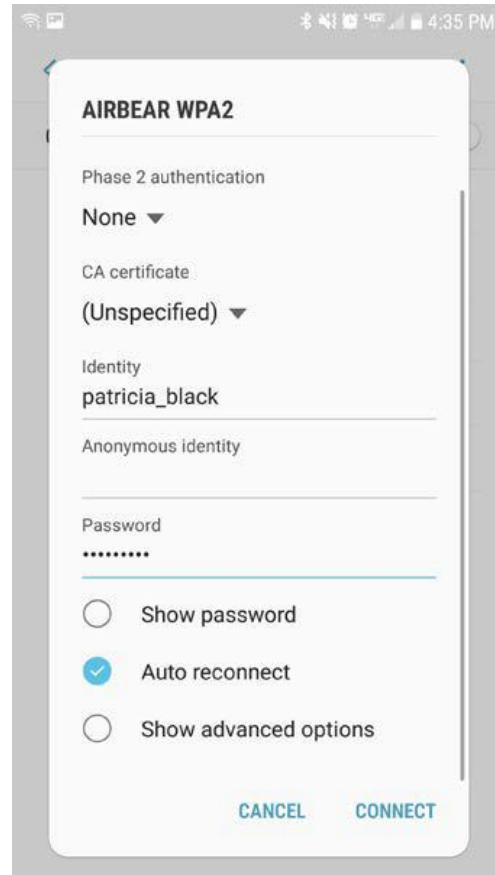

Step 6: Your device should connect to AIRBEAR WPA2.

